

# STL MIKRO

25 W Surface Mounted Single Module  
Linear LED Luminaire

Order Code : 3103279  
Product Code : STL 025U 40OD28 1K9 146TK3I LN5XMC



## Product Data

### Standard Features

|              |   |
|--------------|---|
| Housing      | : RAL 7047 Powder finished aluminium extrusion housing, aluminium injection cover |
| Diffuser     | : Glare minimizing highly permeable diffuser                                      |
| Ceiling Type | : Plasterboard  |
| IP Grade     | : IP40  |
| Installation | : Recessed mounted  |
| Light Source | : Mid Power LED   |

### Optical & Electrical Features

|                              |                  |
|------------------------------|------------------|
| Power Consumption            | : 25.5 W         |
| Final Luminous Flux          | : 1990.1 lm      |
| Efficacy                     | : 77.9 lm/W      |
| Input Voltage                | : 220-240 24V DC |
| Frequency                    | : 50-60 Hz       |
| Power Factor                 | : > 0,9          |
| Correlated Color Temperature | : 4000K          |
| Color Rendering Index        | : >80            |

\*There is ±%10 tolerance in the technical values.

### Other Features & Conditions

|                             |                             |
|-----------------------------|-----------------------------|
| Operating Temperature Range | : -25 °C/+40 °C             |
| Impact Resistance           | : IK02                      |
| Led Life Time - L70         | : > 72.000 hours @Ta= 40 °C |

## Photometric Curve

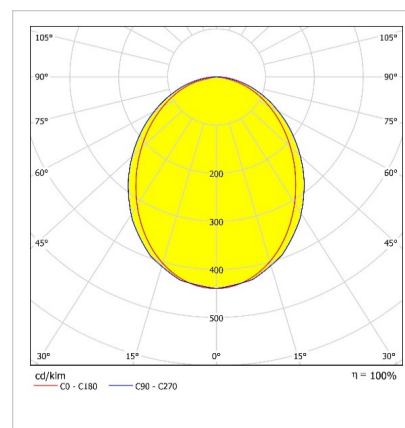

### Optional Features

|                               |                |
|-------------------------------|----------------|
| Correlated Color Temperatures | : 2700K, 3000K |
| Color Option                  | : RAL 9005     |

# STL MIKRO

25 W Surface Mounted Single Module Linear LED Luminaire

3103279 STL 025U 40OD28 1K9 146TK3I LN5XMC

## Dimensions (mm)

|                     | a      | b  | h  |
|---------------------|--------|----|----|
| Single Module       | 1468.5 | 40 | 40 |
| Starting Module     | 1465,5 | 40 | 40 |
| Finishing Module    | 1465,5 | 40 | 40 |
| Intermediate Module | 1462,5 | 40 | 40 |

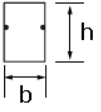
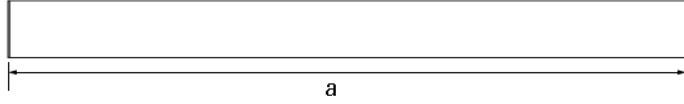

## Weight (kg)

|          |   |
|----------|---|
| Standard | 3 |
|----------|---|

- EAE, reserves the right to make changes without prior notice.



**EAE Aydınlatma A.Ş.**

İkitelli Organize Sanayi Bölgesi Eski Turgut Özal Caddesi No:20 Başakşehir / İSTANBUL-TURKEY Phone: +90 212 413 21 00 (pbx) Fax: +90 212 549 37 90  
[www.eaeaydinlatma.com.tr](http://www.eaeaydinlatma.com.tr)

Revision date: 10.02.2020