

STL MIKRO

30 W Surface Mounted Single Module
Linear LED Luminaire

Order Code : 3103291
Product Code : STL 030U 40OD28 2K3 175TK3I LN6XMC



Product Data

Standard Features

Housing	: RAL 7047 Powder finished aluminium extrusion housing, aluminium injection cover
Diffuser	: Glare minimizing highly permeable diffuser
Ceiling Type	: Plasterboard
IP Grade	: IP40
Installation	: Recessed mounted
Light Source	: Mid Power LED

Optical & Electrical Features

Power Consumption	: 29.9 W
Final Luminous Flux	: 2327.7 lm
Efficacy	: 77.6 lm/W
Input Voltage	: 220-240 24V DC
Frequency	: 50-60 Hz
Power Factor	: > 0,9
Correlated Color Temperature	: 4000K
Color Rendering Index	: >80

*There is $\pm 10\%$ tolerance in the technical values.

Photometric Curve

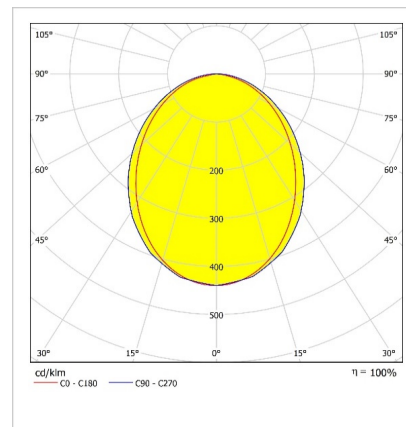

Other Features & Conditions

Operating Temperature Range	: -25 °C/+40 °C
Impact Resistance	: IK02
Led Life Time - L70	: > 72.000 hours @Ta= 40 °C

Optional Features

Correlated Color Temperatures	: 2700K, 3000K
Color Option	: RAL 9005

STL MIKRO

30 W Surface Mounted Single Module Linear LED Luminaire

3103291 STL 030U 40OD28 2K3 175TK3I LN6XMC

Dimensions (mm)

	a	b	h
Single Module	1761	40	40
Starting Module	1756	40	40
Finishing Module	1756	40	40
Intermediate Module	1755	40	40

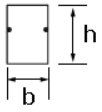
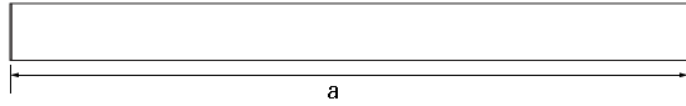

Weight (kg)

Standard	3,4
----------	-----

- EAE, reserves the right to make changes without prior notice.



EAE Aydınlatma A.Ş.
İkitelli Organize Sanayi Bölgesi Eski Turgut Özal Caddesi No:20 Başakşehir / İSTANBUL-TURKEY
www.eaeaydinlatma.com.tr

Revision date: 10.02.2020